

AeroVent Plus™

Collapsible Holding Chamber (CHC)



Monaghan Medical Corporation
Plattsburgh, NY 12901
www.monaghanmed.com



6 04351 85810 7

Part No.	Description	Case
PN 85810	AeroVent Plus® CHC	cs/10
PN 85850	AeroVent Plus® CHC	cs/50

This device was not made or manufactured with Bisphenol A (BPA) or Natural Rubber Latex. This device was Made in the USA from French and US parts.

AeroVent Plus® CHC is a single patient use collapsible holding chamber (CHC) used to administer metered dose inhaler medications into a ventilator circuit. It is designed only for use in the inspiratory limb of a breathing circuit, to accommodate conventional pMDI canisters as well as most pMDI canisters with integrated dose counter (GSK type) while maintaining the counter function.

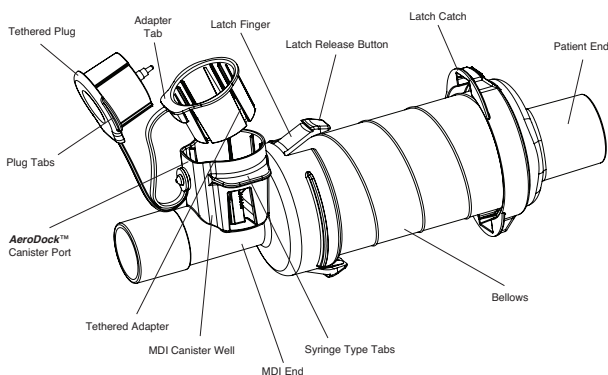

CAUTION: The **AeroVent Plus®** CHC is designed for use only in the inspiratory limb of a breathing circuit. Use of the **AeroVent Plus®** CHC in any other part of the breathing circuit is not recommended.

- SINGLE PATIENT USE ONLY
- DO NOT STERILIZE
- CHANGE WITH CIRCUIT
- DO NOT REUSE

CAUTION: Federal Law restricts this device to sale by or on the order of a physician.

INSTRUCTIONS FOR USE

To install the **AeroVent Plus®** CHC in the ventilator circuit:

1. Remove the **AeroVent Plus®** CHC from its packaging, and inspect for damage or missing components.

WARNING: Ensure that the tethered adapter and plug are correctly seated in the MDI canister well.

2. Insert the **AeroVent Plus®** CHC between the inspiratory limb of the ventilator circuit and the patient wye taking care not to deform or crush the bellows. The MDI end of the device should be distal to the patient. The patient end should be connected to the wye. The tethered plug covering the MDI canister well should be facing up.

CAUTION: To avoid circuit disconnects, ensure that connections are properly secured as intended.

3. Collapse the **AeroVent Plus®** CHC by gently pushing the MDI end and the patient end together, while maintaining alignment of the latch fingers with each corresponding latch catch. When the latches engage you will hear a "click" from each latch (the clicks may occur simultaneously).

WARNING: Ensure that the device is fully collapsed and that the latches are completely engaged by lightly pulling the ends away from each other. The device should remain closed, if not repeat the latching step.

WARNING: The **AeroVent Plus®** CHC should always remain in the closed position in the circuit except while administering medication.

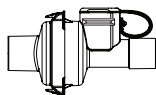

Correct

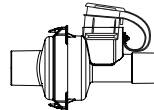

Incorrect

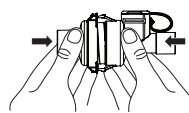

Aligning latch fingers

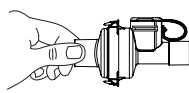

Fully closed



To use the *AeroVent Plus*® to administer medication

1. To expand the *AeroVent Plus*®, with one hand hold the wye connector close to the wye (Figure 1A). Next position thumb and index finger of the other hand on the Latch Release Buttons and press together until they disengage (Figure 1B). When the latches disengage, hold the patient end stationary, while gently pulling the MDI end away from the patient end until the bellows are fully extended (Figure 1C).

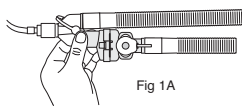

Fig 1A

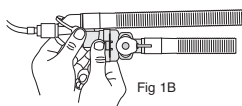

Fig 1B

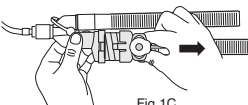

Fig 1C

NOTE: The MDI stem pocket, located in the *AeroDock*™ canister port, has been designed to accept most plastic and metal MDI canister stems.

2. **For Conventional MDI Canisters:** Prepare the MDI canister by shaking per the manufacturer's instructions. Remove the tethered plug in the *AeroDock*™ canister port by gripping the protruding plug tabs and pulling upwards with a slight twisting motion, until the plug is out of the stem pocket. Ensure that the tethered adapter is in its original position in the MDI canister well. Push the plug to one side to allow the insertion of the conventional MDI canister into the tethered adapter, ensuring that the stem of the canister engages the stem pocket of the *AeroVent Plus*® CHC, being careful not to discharge the MDI at this time.

3. **For MDI Canisters With Integrated Dose Counters (GSK type):** Prepare the MDI canister by shaking per the manufacturer's instructions. Remove the tethered plug, located in the *AeroDock*™ canister port, by gripping the protruding plug tabs and pulling upwards with a slight twisting motion, until the plug is out of the stem pocket. Remove the tethered adapter by gripping the smaller protruding adapter tabs and pulling upwards with a slight twisting motion, until the adapter is out of the MDI canister well. Push both the plug and adapter to the side to allow the insertion of the MDI canister with integrated counter into the canister well, ensuring that the stem of the canister engages the stem pocket of the *AeroVent Plus*® CHC, being careful not to discharge the MDI at this time. The integrated counter will be functional upon actuation.

4. Hold the open bellows in your hand maintaining a straight horizontal position. At the onset of inspiration, or as you first feel the bellows expand, actuate the MDI by compressing the concave top of the canister with your thumb, against your index and second finger on the bottom of the syringe-type tabs (Figure 4). A physician or other qualified health care professional shall prescribe the number of actuations.

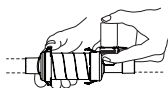

Fig 4

WARNING: Ensure that the device is fully extended prior to actuating the canister.

CAUTION: Use only enough force to actuate the MDI. Excessive force may cause the MDI nozzle to become jammed in the MDI receptacle port. Damage may result.

5. Upon completion of the medication administration, remove the MDI canister from the *AeroVent Plus*® CHC. Replace the tethered adapter (if removed) and tethered plug noting the orientation of the tether straps inline with and looping towards the upstream end of the vent line.

WARNING: Ensure that the tethered adapter and tethered plug are properly seated in the MDI canister well, by pressing down firmly until flush with the top of the well edge.

NOTE: With use it is normal that the inside of the bellows of the *AeroVent Plus*® CHC may appear cloudy due to accumulation of moisture and/or drug/excipient residue.

6. Collapse the *AeroVent Plus*® CHC as described above, Instructions for Use, step 3.

WARNING: Ensure that the device is fully collapsed and that the latches are completely engaged by lightly pulling the ends away from each other.

WARNING: The *AeroVent Plus*® CHC should always remain in the closed position except while administering medication.

